



E60066

COUPLING 25-6-10-32-KV



Accessories

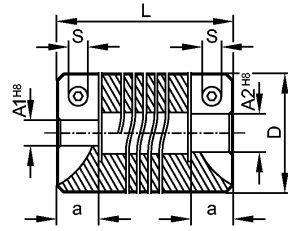

Product characteristics

Flexible coupling with clamp connection [KV]

Ø 6 mm / Ø 10 mm

Mechanical data

Dimension [mm]	D: 25 A1: 6 A2: 10 L: 32 a: 8 S: M3
Max. permissible rpm [1/min]	6000
Max. torque [Ncm]	120
Max. torque clamping screws [Ncm]	100
Rigidity of the torsion spring [Nm/rad]	16
Displacement	max. radial displacement: ± 0.35 mm max. angular displacement: ± 4.0 ° max. axial displacement: ± 0.5 mm
Housing materials	aluminium
Weight [kg]	0.035

Remarks

Remarks	The data indicated apply to couplings with the above hub borings at an ambient temperature of 23 °C. The values of radial, angular and axial displacement are maximum values which must not reach their maximum simultaneously while in operation.
---------	---

Pack quantity [piece]	1
-----------------------	---