

IGT249

IGK3012-BPKG/AM/P/US-104-DPS

Inductive sensors

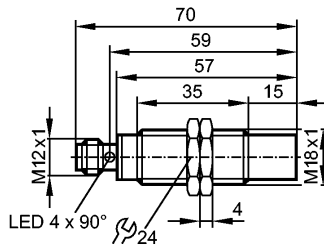

Made in Germany



Product characteristics

Inductive sensor
Metal thread M18 x 1
Connector
Full metal housing
Increased sensing range
Gold-plated contacts
Sensing range 12 mm; [nf] non-flush mountable

Electrical data

Electrical design	DC PNP
Operating voltage [V]	10...36 DC
Current consumption [mA]	< 25
Protection class	III
Reverse polarity protection	yes

Outputs

Output function	normally open
Voltage drop [V]	< 2.5
Leakage current [mA]	< 0.1
Current rating [mA]	100
Short-circuit protection	pulsed
Overload protection	yes
Switching frequency [Hz]	500

Range

Sensing range [mm]	12
Real sensing range (Sr) [mm]	12 ± 10 %
Operating distance [mm]	0...9.7

Accuracy / deviations

Correction factors	mild steel = 1 / stainless steel = 1 / brass approx. 0.7 / aluminium approx. 0.6 / Cu approx. 0.4
Hysteresis [% of Sr]	1...20
Switch-point drift [% of Sr]	-10...10

Environment

Pressure rating [bar]	100; *)
Ambient temperature [°C]	0...100
Protection	IP 65 / IP 67 / IP 68 / IP 69K

Tests / approvals

EMC	EN 61000-4-2 ESD:	4 kV CD / 8 kV AD
-----	-------------------	-------------------

IGT249

IGK3012-BPKG/AM/P/US-104-DPS

Inductive sensors

	EN 61000-4-3 HF radiated:	10 V/m (80...2000 MHz)
	EN 61000-4-4 Burst:	2 kV
	EN 61000-4-6 HF conducted:	10 V (0.15...80 MHz)
	EN 55011 (Emission):	class B
Impact resistance	DIN EN 60068-2-75 Ehc:	1 J
MTTF [Years]		718

Mechanical data

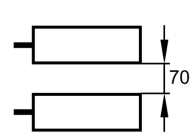
Mounting	non-flush mountable	
Housing materials	housing: stainless steel 316L / 1.4404; active face: stainless steel 316L / 1.4404; lock nuts: stainless steel 316L / 1.4404; connector: PEI	
Installation		
Weight [kg]		0.057

Displays / operating elements

Output status indication	LED	yellow (4 x 90°)
--------------------------	-----	------------------

Electrical connection

Connection	M12 connector; Gold-plated contacts	
------------	-------------------------------------	--

Wiring

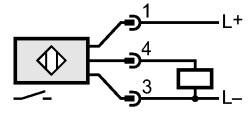
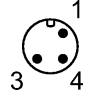

Accessories

Accessories (included)	2 lock nuts	
------------------------	-------------	--

Remarks

Remarks	*) sensing face	
Pack quantity [piece]		1