

**IIC219**

IIC3022-BPKG/M/K1/US-104-DPS

Inductive sensors

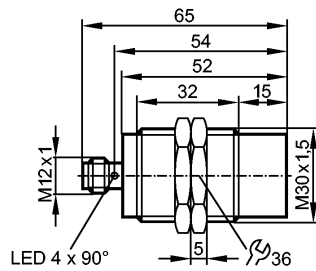

Made in Germany



**Product characteristics**

Inductive sensor
Metal thread M30 x 1.5
Connector
Electromagnetic-field immune
Gold-plated contacts
Correction factor = 1
Sensing range 22 mm; [nf] non-flush mountable

**Electrical data**

Electrical design	DC PNP
Operating voltage [V]	10...30 DC *)
Current consumption [mA]	< 15
Protection class	II
Reverse polarity protection	yes

**Outputs**

Output function	normally open
Voltage drop [V]	< 2.5
Leakage current [mA]	< 0.1
Current rating [mA]	200
Short-circuit protection	pulsed
Overload protection	yes
Switching frequency [Hz]	1000

**Range**

Sensing range [mm]	22
Real sensing range (Sr) [mm]	22 ± 10 %
Operating distance [mm]	0...17.82

**Accuracy / deviations**

Correction factors	mild steel = 1 / stainless steel approx. 1 / brass approx. 1 / aluminium approx. 1 / copper approx. 1
Hysteresis [% of Sr]	1...15
Switch-point drift [% of Sr]	-10...10

**Environment**

Ambient temperature [°C]	-25...70
Protection	IP 68; "Coolant"

**Tests / approvals**

EMC	EN 61000-4-2 ESD: 4 kV CD / 8 kV AD EN 61000-4-3 HF radiated: 10 V/m (80...1000 MHz)
-----	---

## IIC219

IIC3022-BPKG/M/K1/US-104-DPS

Inductive sensors

	EN 61000-4-4 Burst:	2 kV
	EN 61000-4-5 Surge:	0.5 kV
	EN 61000-4-6 HF conducted:	10 V (0.15...80 MHz)
	EN 55011:	class B
MTTF	[Years]	1915

### Mechanical data

Mounting	non-flush mountable
Housing materials	stainless steel (316L); active face: PBT; lock nuts: Brass
Weight	[kg] 0.112

### Displays / operating elements

Output status indication	LED	yellow (4 x 90°)
--------------------------	-----	------------------

### Electrical connection

Connection	M12 connector; Gold-plated contacts
------------	-------------------------------------

### Wiring

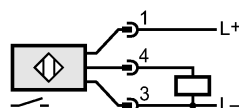

### Accessories

Accessories (included)	2 lock nuts
------------------------	-------------

### Remarks

Remarks	*) cULus - Class 2 source required
---------	------------------------------------

Pack quantity	[piece] 1
---------------	-----------